



LR105922



MODEL WRT-150

SEMI AUTOMATIC FREE STANDING ROTARY ARM
(WITH NO-THREAD[®] POWERED PRE-STRETCH CARRIAGE)

MODEL WRT-150 MACHINE SPECIFICATIONS SEMI AUTOMATIC FREE STANDING ROTARY ARM

CAPACITIES

PRODUCTION

- Up to 50 pallets per hr., based on load size and configuration

LOAD WEIGHT

- Unlimited

APPROX SHIPPING WEIGHT

- 2,026lbs.

LOAD SIZE

- 52" x 52" x 80"H

ELECTRICAL REQUIREMENTS

- 120V/1/60 15A

MACHINE DIMENSIONS

- 130"W x 165½"L x 120⅞"H *

* Overall dimensions of machine in operation

FEATURES

CONTROLS

- Allen Bradley Micrologix 1200 PLC
- 24V control system
- Current overload protection
- Nema 4/12 control cabinet with quick disconnect
- Auto-height sensing photoeye with on/off switch
- Power on/off switch and indicator light
- Start/stop push button
- Large emergency stop (push pull type)
- Manual carriage up/down switch
- Variable rotary arm speed (12 RPM)
- Separate up and down carriage speeds
- Separate top and bottom wrap selectors (0-9)
- Reinforce wrap/manual rotation control
- Positive arm alignment
- Top cover pause switch (Splash-proof Program)
- Spiral up or spiral up/down switch
- Film force to load control
- Double brush dust tight slip ring
- Emergency stop sensor for arm path obstruction
- Panel can be located up to 10' from machine frame

FILM DELIVERY SYSTEM

- 20" NO-THREAD[®] Powered Pre-Stretch Carriage
- 1/2 HP AC motor with Allen Bradley variable frequency drive
- 50-300% prestretch ratio (preset to customer spec, Std 200%)
- Electronic film tension control with analog sensor
- Lexan roller cover
- Film force release for easy pull at start and end of cycle
- Angled carriage to wrap approximately 2" from floor level

FILM CARRIAGE DRIVE

- 1/2 HP AC motor with Allen Bradley variable frequency drive
- Two #50 chain carriage lifts for safety
- Dual ½" CRS ways with UHMW-PE carriage glides
- Dual structural steel boom
- Power track for efficient guiding of wires

ROTARY ARM

- All structural steel construction
- Floor mounting with 10 anchor points
- 10" square tubing column

ROTARY ARM DRIVE

- 25" **Ring Gear Bearing** drive/support
- Max. 12 RPM variable speed
- 3/4 HP AC motor with Allen Bradley variable frequency drive
- Electronic soft start/stop
- Positive arm alignment controlled by proximity sensor
- Protection guard over the ring gear

STRUCTURE

- Floor mounting integrated design
- Heavy duty structural steel construction
- Easy access to all components
- Swivel option available

TECHNICAL INFORMATION

- The machine is provided with a manual including electro/mechanical schematics and drawings
- Trouble shooting guide
- Installation instructions

WARRANTY

- All Wulftec semi automatic machines come with a three year warranty. **All 25" ring gear bearings are warranted for ten years.**
- All Wulftec prestretch compound rollers have a lifetime warranty. (see Chapter 9 for complete warranty)



LR105922



 209 Wulftec
 Ayer's Cliff, Quebec, Canada
 J0B 1C0

 Tel.: (819) 838-4232
 Fax: (819) 838-5539
 Toll free (877) WULFTEC
 (877) 985-3832

 E Mail: wulftec@wulftec.com
 Web Site: <http://www.wulftec.com>

DISTRIBUTED BY:

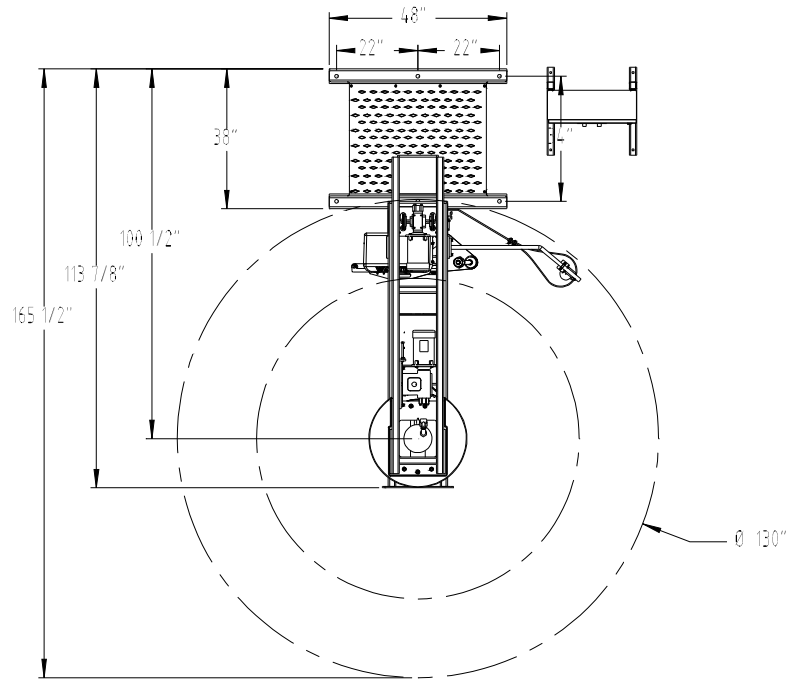
Note: All machine specifications and pricing are subject to change without prior notice.



5/4/04

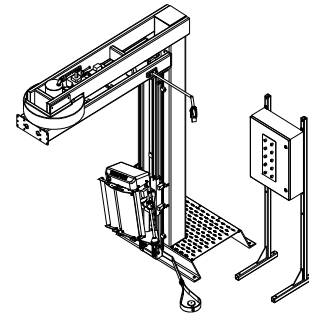
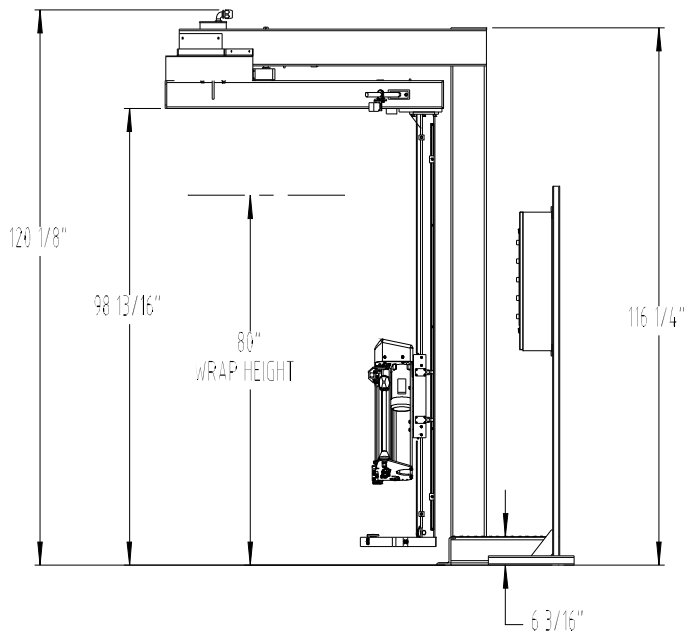

LR105922



MODEL WRT-150

FREE STANDING ROTARY ARM

(WITH NO-THREAD[®] POWERED PRE-STRETCH CARRIAGE)