



MODEL WHPA-300 8,000 lb. Capacity
HEAVY DUTY RING GEAR DRIVEN PORTABLE AUTOMATIC TURNTABLE
(WITH NO-THREAD[®] POWERED PRE-STRETCH CARRIAGE)

MODEL WHPA-300 MACHINE SPECIFICATIONS

HEAVY DUTY RING GEAR DRIVEN PORTABLE AUTOMATIC TURNTABLE

CAPACITIES

<p><u>PRODUCTION</u></p> <ul style="list-style-type: none"> - Up to 55 loads per hr., based on load configuration and machine options <p><u>LOAD WEIGHT</u></p> <ul style="list-style-type: none"> - 8,000 lbs. <p><u>APPROX SHIPPING WEIGHT</u></p> <ul style="list-style-type: none"> - 2,674 lbs. 	<p><u>LOAD SIZE</u></p> <ul style="list-style-type: none"> - Min. - 36"W x 36"L x 10"H - Max. - 51"W x 51"L x 80"H <p><u>ELECTRICAL REQUIREMENTS</u></p> <ul style="list-style-type: none"> - 230V/3/60 	<p><u>PNEUMATIC REQ.</u></p> <ul style="list-style-type: none"> - 3 CFM @ 80 PSI comes with FR (Filter, Regulator) <p><u>MACHINE DIMENSIONS *</u></p> <p>51"W x 120"L x 96"H</p> <p>* Machine height can exceed by up to 8" when carriage in upmost position.</p>
--	--	--

FEATURES

<p><u>CONTROLS</u></p> <ul style="list-style-type: none"> - Allen Bradley Micrologix 1200 PLC - 24V control system - Current overload protection with AC drive - Control cabinet incorporated in tower - Autoheight sensing photoeye with on/off mode - Power on/off lockable switch and indicator light - Large emergency stop (push pull type) - Allen Bradley monochrome Touch Panel - 15 RPM variable table speed - 12 RPM with 8,000 lbs load - Separate up and down carriage speed control - Separate top and bottom wrap selection (0-9) - Film force to load control - Alarm beacon - Manual clamp jog - Reset function - Pull cord switch with 40' of cable (to be installed by customer) - 120 VAC outlet in control panel for service work - Manual function for table and carriage - Intuitive alarm diagnostics on touch screen <p><u>FILM DELIVERY SYSTEM</u></p> <ul style="list-style-type: none"> - 20" NO-THREAD[®] Powered Pre-Stretch Carriage - 1/2 HP AC motor with Allen Bradley variable frequency drive - 50-300% prestretch ratio (preset to customer spec, Std 200%) - Electronic film tension control with analog sensor - Sensing device for film out/broken - Lexan roller cover - Film force release for easy pull at start and end of cycle <p><u>FILM CARRIAGE DRIVE</u></p> <ul style="list-style-type: none"> - 3/4 HP AC motor with Allen Bradley variable frequency drive - Two #50 chain carriage lifts for safety - Dual 1/2" CRS ways with UHMW-PE carriage glides 	<p><u>FILM TAIL TREATMENT</u></p> <ul style="list-style-type: none"> - Automatic film clamping device - Pulsed controlled cutter - Film alignment arm - Brush-on film tail treatment - Air pressure switch <p><u>TURNTABLE</u></p> <ul style="list-style-type: none"> - 51" X 51" X 1/2" formed steel octagonal table <p><u>TURNTABLE DRIVE</u></p> <ul style="list-style-type: none"> - Max. 15 RPM variable speed - 1-1/2 HP AC motor with Allen Bradley variable frequency drive - Heavy duty Ring Gear Bearing drive - Automated lube station - Electronic soft start/stop - Positive turntable alignment controlled by proximity sensor - Extra heavy duty transmission <p><u>STRUCTURE</u></p> <ul style="list-style-type: none"> - Formed steel tower consisting of 11 gauge front section and 14 gauge back cabinet section with lockable door - Forklift portable base design (from both ends) - Heavy duty structural steel construction - Lag bolt brackets to secure machine to the floor <p><u>TECHNICAL INFORMATION</u></p> <ul style="list-style-type: none"> - The machine is provided with a manual including electro/mechanical schematics and drawings - Trouble shooting guide - Installation instructions <p><u>WARRANTY</u></p> <ul style="list-style-type: none"> - All Wulftec[®] automatic machines come with a three year warranty - All 25" ring gear bearings are warranted for ten years - All Wulftec prestretch compound rollers have a lifetime warranty (see Chapter 9 for complete warranty)
--	--



LR105922



 209 Wulftec
 Ayer's Cliff, Quebec, Canada
 J0B 1C0

 Tel.: (819) 838-4232
 Fax: (819) 838-5539
 Toll free (877) WULFTEC
 (877) 985-3832

 E Mail: wulftec@wulftec.com
 Web Site: <http://www.wulftec.com>

DISTRIBUTED BY:

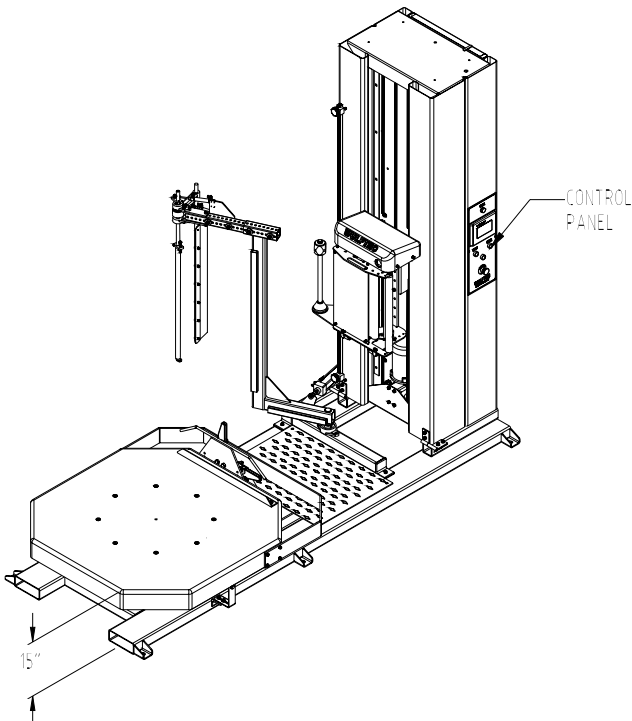
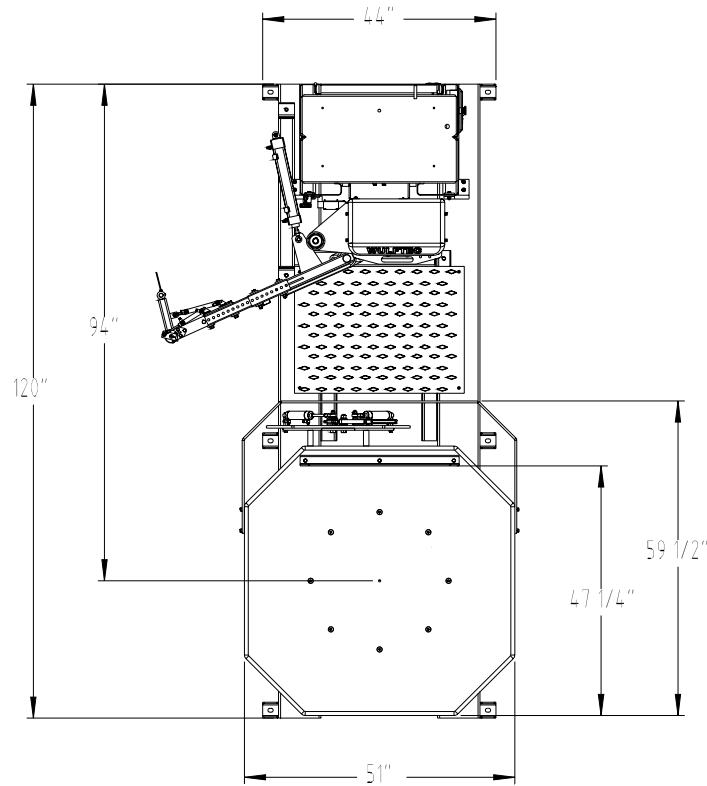
Note: All machine specifications and pricing are subject to change without prior notice.



LR105922



MODEL WHPA-300

8,000 lb. Capacity

**HEAVY DUTY RING GEAR DRIVEN
PORTABLE AUTOMATIC TURNTABLE
(WITH NO-THREAD[®] POWERED
PRE-STRETCH CARRIAGE)**

5/4/04